

外形及安装尺寸 Mounting and overall dimensions

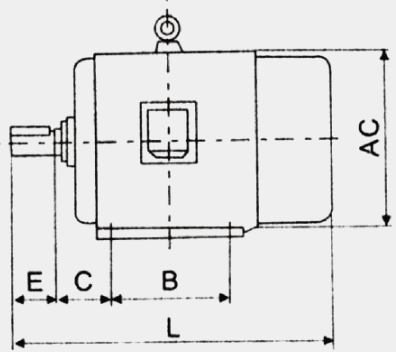

IMB3

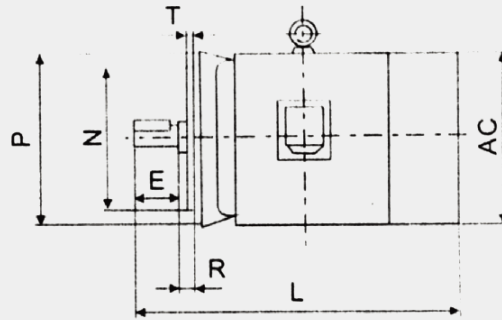
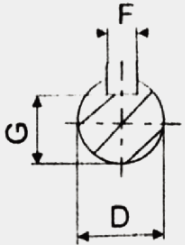
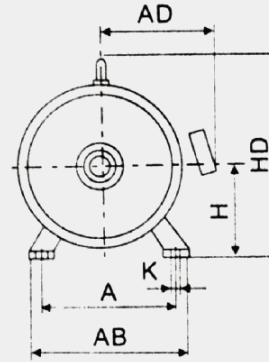

IMB5

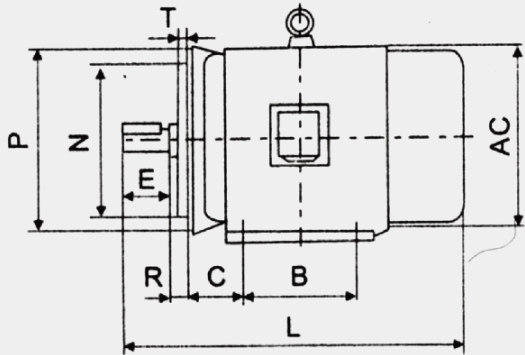
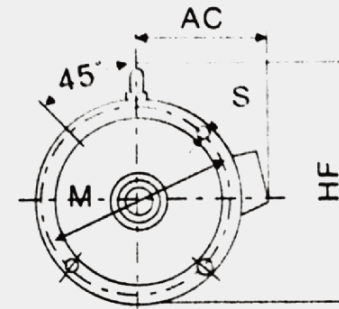

IMB35

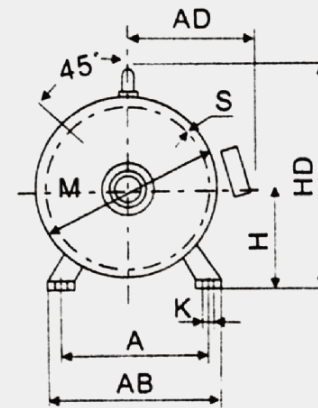

技术数据 Technical data

机座号 Frame Size	安装尺寸 Mounting dimensions															外形尺寸 Overall dimensions					
	A	B	C	D	E	F	G	H	K	M	N	P	R	S	T	AB	AC	AD	HD	HF	L
80	125	100	50	19	40	6	15.5	80	10	165	130	200	0	4-12	3.5	165	165	150	170	185	290
90S	140	100	56	24	50	8	20	90	10	165	130	200	0	4-12	3.5	180	195	160	190	195	315
90L	140	125	56	24	50	8	20	90	10	165	130	200	0	4-12	3.5	180	195	160	190	195	340
100L	160	140	63	28	60	8	24	100	12	215	180	250	0	4-15	4	205	215	180	245	245	380
112M	190	140	70	28	60	8	24	112	12	215	180	250	0	4-15	4	245	240	190	265	265	400
132S	216	140	89	38	80	10	33	132	12	265	230	300	0	4-15	4	280	275	210	315	315	475
132M	216	178	89	38	80	10	33	132	12	265	230	300	0	4-15	4	280	275	210	315	315	515
160M	254	210	108	42	110	12	37	160	15	300	250	350	0	4-19	5	330	325	255	385	485	600
160L	254	254	108	42	110	12	37	160	15	300	250	350	0	4-19	5	330	325	255	385	485	645
180M	279	241	121	48	110	14	42.5	180	15	300	250	350	0	4-19	5	355	360	285	430	430	670
180L	279	279	121	48	110	14	42.5	180	15	300	250	350	0	4-19	5	355	360	285	430	430	710
200L	318	305	133	55	11	16	49	200	19	350	300	400	0	4-19	5	395	400	310	475	480	775
225S	356	286	149	2P: 55	2P: 110	2P: 16	2P: 49	225	19	400	350	450	0	8-19	5	535	450	345	530	535	820
				60	140	18	53														
225M	356	311	149	2P: 55	2P: 110	2P: 16	2P: 49	225	19	400	350	450	0	8-19	5	435	450	345	530	535	820
				60	140	18	53														845
250M	406	349	168	2P: 55	140	18	2P: 53	250	24	500	450	550	0	8-19	5	490	495	385	575	-	930
				60			58														

技术数据 Technical data

型号 Type	功率 Output (Kw)	电流 Current (A)	转速 Speed (r/min)	效率 Eff (%)	功率因素 Power factor (cos)	堵转转矩 Locked rotor torque	堵转电流 Locked rotor current	最大转矩 Pull-out torque	重量 Weight (Kg)	
						额定转矩 Rated torque	额定电流 Rated current	额定转矩 Rated torque		
YD801-	4	0.45	1.4	1420	66	0.74	1.5	6.5	1.8	17
	2	0.55	1.5	2860	65	0.85	1.6	7	1.8	
YD802-	4	0.55	1.7	1420	68	0.74	1.5	6.5	1.8	10

YD90S-	2	0.75	2.0	2860	66	0.85	1.6	7	1.8	10
YD90S-	4	0.85	2.3	1430	74	0.77	1.5	6.5	1.8	22
	2	1.1	2.8	2850	72	0.84	1.6	7	1.8	
YD90L-	4	1.3	3.3	1430	76	0.78	1.5	6.5	1.8	27
	2	1.8	4.3	2850	74	0.84	1.6	7	1.8	
YD100L1-	4	2	4.8	1430	78	0.81	1.5	6.5	1.8	33
	2	2.4	5.6	2850	76	0.86	1.6	7	1.8	
YD100L2-	4	2.4	5.6	1430	79	0.83	1.5	6.5	1.8	38
	2	3.0	6.7	2850	77	0.89	1.6	7	1.8	
YD112M-	4	3.3	7.4	1450	81	0.83	1.5	6.5	1.8	51
	2	4.0	8.6	2860	80	0.88	1.6	7	1.8	
YD132S-	4	4.5	9.8	1450	83	0.84	1.5	6.5	1.8	68
	2	5.5	11.9	2860	79	0.88	1.6	7	1.8	
YD132M-	4	6.5	13.8	1450	84	0.85	1.5	6.5	1.8	78
	2	8	17.1	2880	80	0.89	1.6	7	1.8	
YD160M-	4	9	18.5	1460	87	0.85	1.5	6.5	1.8	123
	2	11	22.9	2920	82	0.89	1.6	7	1.8	
YD160L-	4	11	22.3	1460	87	0.86	1.5	6.5	1.8	144
	2	14	28.8	2920	82	0.90	1.6	7	1.8	
YD180M-	4	15	29.4	1470	89	0.87	1.5	6.5	1.8	182
	2	18.5	36.7	2940	85	0.9	1.6	7	1.8	
YD180L-	4	18.5	35.9	1470	89	0.88	1.5	6.5	1.8	190
	2	22	42.7	2940	86	0.91	1.6	7	1.8	

技术数据 Technical data

型号 Type	功率 Output (Kw)	电流 Current (A)	转速 Speed (r/min)	效率 Eff (%)	功率因素 Power factor (cos ϕ)	堵转转矩 Locked rotor torque	堵转电流 Locked rotor current	最大转矩 Pull-out torque	重量 Weight (Kg)	
						额定转矩 Rated torque	额定电流 Rated current	额定转矩 Rated torque		
YD200L-	4	26	49.9	1470	89	0.89	1.4	6.5	1.8	270
	2	30	58.3	2950	85	0.92	1.4	7	1.8	
YD225S-	4	32	60.7	1480	90	0.89	1.4	6.5	1.8	318
	2	37	71.7	2960	86	0.92	1.4	7	1.8	
YD225M-	4	37	69.4	1480	91	0.89	1.4	6.5	1.8	354
	2	45	86.4	2960	87	0.92	1.4	7	1.8	
YD250M	4	45	84.4	1480	91	0.89	1.4	6.5	1.8	427

YD250UM-	2	55	103.2	2960	88	0.92	1.4	7	1.8	421
YD90S-	6	0.65	2.2	920	64	0.70	1.4	6	1.8	23
	4	0.85	2.3	1420	70	0.79	1.3	6.5	1.8	
YD90L-	6	0.85	2.8	930	66	0.70	1.4	6	1.8	25
	4	1.1	3.0	1420	71	0.79	1.3	6.5	1.8	
YD100L1-	6	1.3	3.8	940	74	0.70	1.4	6	1.8	34
	4	1.8	4.4	1440	77	0.80	1.3	6.5	1.8	
YD100L2-	6	1.5	4.3	940	75	0.70	1.4	6	1.8	38
	4	2.2	5.4	1440	77	0.80	1.4	6.5	1.8	
YD112M-	6	2.2	5.7	960	77	0.75	1.4	6	1.8	49
	4	2.8	6.7	1440	77	0.82	1.3	6.5	1.8	
YD132S-	6	3	7.7	960	79	0.75	1.4	6	1.8	63
	4	4	9.5	1440	80	0.82	1.3	6.5	1.8	
YD132M-	6	4	9.8	960	81	0.76	1.4	6	1.8	80
	4	5.5	12.3	1440	80	0.85	1.3	6.5	1.8	
YD160M-	6	6.5	15.1	970	84	0.78	1.4	6	1.8	119
	4	8	17.4	1460	83	0.85	1.3	6.5	1.8	
YD160L-	6	9	20.6	970	85	0.78	1.4	6	1.8	147
	4	11	23.4	1460	84	0.85	1.3	6.5	1.8	
YD180M-	6	11	25.9	980	85	0.78	1.4	6	1.8	192
	4	14	29.8	1470	85	0.85	1.3	6.5	1.8	
YD180L-	6	13	29.4	980	86	0.78	1.4	6	1.8	224
	4	16	33.6	1470	85	0.85	1.3	6.5	1.8	
YD200L-	6	18.5	41.4	980	87	0.78	1.4	6.5	1.8	250
	4	22	44.7	1460	87	0.86	1.3	7	1.8	
YD225S-	6	22	44.2	980	88	0.86	1.4	6.5	1.8	270
	4	28	56.2	1470	87	0.87	1.3	7	1.8	
YD225M-	6	26	52.2	980	88	0.86	1.4	6.5	1.8	330
	4	34	66.0	1470	87	0.90	1.3	7	1.8	
YD250M-	6	32	62.1	980	90	0.87	1.4	6.5	1.8	340
	4	42	74.7	1470	88	0.91	1.3	7	1.8	
YD280S-	6	42	80.4	980	91.47	0.868	1.4	6.5	1.8	479
	4	55	101.9	1480	90.42	0.907	1.5	7	1.8	
YD280M-	6	55	104.8	980	92.06	0.866	1.4	6.5	1.8	
	4	72	135.2	1480	90.66	0.891	1.5	7	1.8	

YD90L-	6	0.45	1.9	680	58	0.63	1.5	5.5	1.8	25	
	4	0.75	1.92	1420	72	0.87	1.5	6.5	1.8		
YD100L-	8	0.85	3.1	700	68	0.63	1.5	5.5	1.8		
	4	1.5	3.5	1420	75	0.88	1.5	6.5	1.8		
YD112M-	8	1.5	5.0	700	72	0.63	1.5	5.5	1.8		479
	4	2.4	5.3	1420	78	0.88	1.5	6.5	1.8		
YD132S-	8	2.2	7.0	720	75	0.64	1.5	5.5	1.8		
	4	3.3	7.1	1440	80	0.88	1.5	6.5	1.8		
YD132M-	8	3	9.0	720	78	0.65	1.5	5.5	1.8		
	4	4.5	9.4	1440	82	0.88	1.5	6.5	1.8		

技术数据 Technical data

型号 Type	功率 Output (kw)	电流 Current (A)	转速 Speed (r/min)	效率 Eff (%)	功率因数 Power Factory (COS ϕ)	堵转转矩 Locked Rotor Torque	堵转电流 Locked Rotor Current	最大转矩 Pull-out Torque	重量 Weight (Kg)	
						额定转矩 Rated Torque	额定电流 Rated Current	额定转矩 RATED Torque		
YD160M-	8	5	13.9	730	83	0.66	1.5	5.5	1.8	119
	4	7.5	15.2	1450	84	0.89	1.5	6.5	1.8	
YD160L-	8	7	19.0	730	85	0.66	1.5	5.5	1.8	147
	4	11	21.8	1450	86	0.89	1.5	6.5	1.8	
YD180L-	8	11	26.0	730	86	0.74	1.5	6	1.8	254
	4	17	31.9	1470	87	0.92	1.5	7	1.8	
YD200L1-	8	14	33.0	740	86	0.74	1.5	6	1.8	270
	4	22	41.3	1470	88	0.92	1.5	7	1.8	
YD200L2-	8	17	40.1	740	87	0.74	1.5	6	1.8	301
	4	26	48.8	1470	88	0.92	1.5	7	1.8	
YD225M-	8	24	53.2	740	89	0.77	1.4	6	1.8	340
	4	34	33.7	1470	88	0.88	1.3	7	1.8	
YD250M-	8	30	64.9	740	90	0.78	1.4	6	1.8	479
	4	42	78.8	1480	89	0.91	1.3	7	1.8	
YD280S	8	40	81.87	730	91.4	0.8	1.4	6	1.8	
	4	55	99.83	1480	90.9	0.9	1.3	7	1.8	
YD280M-	8	47	94.59	730	91.9	0.8	1.4	6	1.8	
	4	66	119.14	1480	91.6	0.91	1.3	7	1.8	
YD90S-	8	0.35	1.6	680	56	0.60	1.5	5	1.8	23

	6	0.45	1.4	930	70	0.72	1.5	6	1.8	
YD90L-	8	0.45	1.9	680	59	0.60	1.5	5	1.8	25
	6	0.65	1.9	930	71	0.73	1.5	6	1.8	
YD100L-	8	0.75	2.9	710	65	0.60	1.5	5	1.8	38
	6	1.1	3.1	950	75	0.73	1.5	6	1.8	
YD112M-	8	1.3	4.5	710	72	0.62	1.5	5	1.8	51
	6	1.8	4.8	950	78	0.73	1.5	6	1.8	
YD132S-	8	1.8	5.8	730	75	0.62	1.5	5	1.8	63
	6	2.4	6.2	970	80	0.73	1.5	6	1.8	
YD132M-	8	2.6	8.2	730	78	0.62	1.5	5	1.8	80
	6	3.7	9.4	970	82	0.73	1.5	6	1.8	
YD160M-	8	4.5	13.3	730	83	0.62	1.5	5	1.8	119
	6	6	14.7	980	85	0.73	1.5	6	1.8	
YD160L-	8	6	17.5	730	84	0.62	1.5	5	1.8	147
	6	8	19.4	980	86	0.73	1.5	6	1.8	
YD180M-	8	7.5	21.9	730	84	0.62	1.5	5	1.8	195
	6	10	24.2	980	86	0.73	1.5	6	1.8	
YD180L-	8	9	24.8	730	85	0.65	1.5	5	1.8	224
	6	12	28.3	980	86	0.75	1.5	6	1.8	
YD200L1	8	12	32.5	730	86	0.65	1.5	5	1.8	250
	6	17	39.1	980	87	0.76	1.5	6	1.8	
YD200L2-	8	15	40.3	730	87	0.65	1.5	5	1.8	301
	6	20	45.4	980	88	0.76	1.5	6	1.8	
YD250M-	8	30	58.1	730	90	0.86	1.5	5	1.8	451
	6	15	33.1	980	88	0.78	1.5	6	1.8	
YD160M-	12	2.6	11.6	480	75	0.46	1.2	5	1.8	119
	6	5.0	11.9	970	84	0.78	1.3	6	1.8	
YD160L-	12	3.7	16.4	480	77	0.46	1.2	4	1.8	147
	6	7.0	15.8	970	85	0.79	1.3	6	1.8	
YD180L-	12	5.5	19.6	490	79	0.54	1.2	4	1.8	224
	6	10	20.5	980	86	0.86	1.3	6	1.8	
YD200L1-	12	7.5	25.1	490	82	0.56	1.2	4	1.8	270
	6	13	26.4	980	87	0.86	1.3	6	1.8	